

W6OTX**W6ARA****PAARA NEWSLETTER**
VOLUME 59, NUMBER 9, September 2009**K6OTA****K6YQT**

PAARAgraphs



The Official Newsletter of the

Palo Alto Amateur Radio Association, Inc.Celebrating 72 years as an *active* amateur radio club—*Since 1937*

CALENDAR

September 4, PAARA Meeting, 7:00 p.m.
Menlo Park Recreation Center
700 Alma Street, Menlo Park**September 23, Board Meeting, 7:10 p.m.**
Palo Alto Red Cross
400 Mitchell Lane

President's Corner Reflector

Joel Wilhite – KD6W

September 2009

Late summer brings shortened days and increased fire danger. On a recent business trip to Burbank, I saw live helicopter coverage of the Angeles National Forest fire. The fire, suspected to have been started by a propane stove, burned 750 acres in the first 24 hours; in under a week it has gobbled up over 5000 acres. On the day it started, I and a few others were watching the live television feed, and we stared in amazement as the fire jumped from one canyon wall to another, ran up a rock face covered in small dry scrub brush, and continued up over a turnout area next to a road. Several people watching from the ledge were caught unaware by the speed of the fire. Within moments of the fire rising over the edge, they all scrambled to move their vehicles away from danger. While most vehicles were moved to safety, one white car parked too close to the edge had to be abandoned.

(Continued on page 37) Pres Corner

PLEASE JOIN US AT OUR
NEXT GENERAL MEETING ON
SEPTEMBER 4, 2009
OUR SPEAKER WILL BE...

Jerry Ramie, KI6LGY

Green Power and the Modern Power Grid

Risk and uncertainty in the electric industry have driven investment to an all-time low. Regulations designed to encourage competition have fallen short of expectations. Several promising technologies could address problems in system operation, but the Information Technologies that have transformed other "networked" industries (like telecom) haven't transformed the electric industry. The proliferation of micro-processors requires greater power quality and reliability. It is increasingly difficult to site transmission lines, thus requiring new power electronic solutions that allow more power flow through existing lines (Flexible AC Transmission Systems, or FACTS) and local (distributed) generation.

Their conclusions were that the "technology readiness" of our critical electric systems needs to be improved. Jerry will tell us more about what happened at their meetings and what to look forward to.

PAARA People and Places

by Moore N Pho 3W1NKS

Summer is nearly over: Operate from remote locations for fun and adventure. Experiment with quick and easy set up, develop skills and test your equipment. Experiment with antennas. Optimize your radios for all mode portable communications. Start with simplicity. Add convenience and variety. Mix them together to create lightweight outdoor adventure.

DXing by the Bay: PAARA's LXpeditionary Force, an informal Special Interest Group (SIG), encourages special events and LXpeditions (local expeditions). Goals are to emphasize radio field operations...

Continued on page 38

VE Exams, 3rd Saturday each month, 10:30AM, 145.23— PL=100Hz
 Redwood City Main Library, Community Conference Room
 1044 Middlefield Road, Redwood City, CA
 contact: <http://amateur-radio.org/> or Al, WB6IMX@att.net

ELECTRONICS FLEA MARKET

Sponsorship by **A.S.V.A.R.O.**
 (Association of Silicon Valley Amateur Radio Organizations)
 Second Saturday of month, March-October, 6am-2pm
 Howard M. Krawetz, N6HM 650-856-9761
 Contact: <http://www.electronicfleamarket.com/>

LIVERMORE SWAP MEET. Now in Robertson Park, Livermore, every first Sunday of the month. 7 am to 11:30 am. Free admission for buyers. For further info, see: www.larkswap.com or contact Ian Parker, W6TCP at swapmeet@livermoreark.org

PAARA Palo Alto Amateur Radio Association

Meets 1st Friday 7:00pm each month at Menlo Park Rec. Center, Net 145.230 each Monday 8:30.
 See our website at <http://www.paara.org/> for more information.
 Or contact: Joel Wilhite KD6W, KD6W@ARRL.NET, 650-325-8239

FARS Foothills Amateur Radio Society

Meets 4th Friday each month at 7:30pm
 contact: <http://www.fars.k6ya.org/>

NCDXC Northern California DX Club

meets 2nd Friday 7:30pm each month,
 repeater for member info 147.360, Thursday 8:00PM
 contact: <http://nedxc.org/> or Mike Gavin W6WZ, (650) 851 8699

QCWA Chapter 11

Northern California Quarter Century Wireless Association
 Meets third Wednesday monthly at Harry's Hofbrau in Redwood City @ 11:30 AM.
 Guests are welcome. Saturday morning net on 146.850 MHz, PL 114.8

NorCalQRP Northern California QRP Club

meets 1st Sunday each month
 contact: <http://www.norcalqrp.org/>

SPECS Southern Peninsula Emergency Communication System

meets each Monday 8:00pm on Net 145.27, 440.80 MHz
 contact: <http://specsnet.org/> or Tom Cascone, KF6LWZ, 650-688-0441

SCARES South County Amateur Radio Emergency Service

meets 3rd Thursday 7:30pm each month, San Carlos City Hall.
 Net is on 146.445 [PL 114.8] & 444.50 (PL-100) 7:30 Monday evenings.
 contact: President Gary D. Aden, K6GDA 650-743-1265(D), 650- 595-5590 (N)
 Web: <http://k6mpn.org> E-mail: pres@k6mpn.org

SCCARA Santa Clara County Amateur Radio Association

Operates W6UU & W6UU/R, repeater 146.985-pl
 Nets: 2m, 7:30pm Mon; 70cm, 442.425+ (pl 107.2) Thur.
 meets 2nd Mon each month @ 7:30 PM.
 contact: <http://www.qsl.net/sccara/> or Clark Murphy KE6KXO 408-262-9334
 ARRL/VEC license testing contact 408-507-4698

SVECS Silicon Valley Emergency Communications

Operates AA6BT repeater (146.115 MHz+)
 contact: <http://www.svecs.net/> or Lou Stierer WA6QYS 408 241 7999

TEARS The Elmer Amateur Radio Society

Dedicated to operational training, knowledge building &
 FCC exam testing. KV6R repeater under construction.
 Contact AA6T@ARRL.NET. Most members are Extra
 class or VE's. See QRZ dot com/kv6r for class info

WVARA West Valley Amateur Radio Association

W6PIY six-meter repeater on 52.58MHz. Normally, six-meters is linked with 147 and 223, while 441 and 1286 repeaters are linked.
 VHF: 52.58 (-500) 151.4 ctcss UHF: 147.39 (+600) 151.4 ctcss 441.35 (+5.0 88.5) ctcss
 223.96 (+1.6) 156.7 ctcss 1286.20 (-12m) 100.0 ctcss

Meetings are 3rd Wednesday of every month.
 contact: <http://wvara.org/>, Bill Ashby N6FFC, 408-267-3118, N6FFC@Juno.com, or N6FFC@ARRL.NET

American Red Cross, SANTA CLARA VALLEY CHAPTER

contact: <http://santaclaravalley.redcross.org/> or Scott Hensley KB6UOO, (408) 967 7924
shensley@Novell.com

(please send changes to PAARAgaphs editor: kd6w@arrl.net)

Please contact Rick Melrose to
 settle your 2009 membership dues so
 you can keep receiving your
 PAARAgaphs

Palo Alto Amateur Radio Association, Inc.

PO Box 911 Menlo Park, CA 94026

Officers

President	Joel Wilhite, KD6W	650 325 8239
	kd6w@arrl.net	
Vice President	Doug Teter, KG6LWE	650-367-6200
	dteter@wvwi.com	
Secretary	Rick Melrose K6RDM	1-888-725-1895
	k6rdm@arrl.net	
Treasurer	Ron Chester, W6AZ	408-243 2221
	ron@taxhelp.com	

Directors

Past President (09)	Kristen McIntire, K6WX	510-703-4942
	kristen@alum.mit.edu	
Director ('10)	Peter Sheerin K6WEB	415 298 7383
	k6web@arrl.net	
Director ('09)	Rob Riley, KG6HVW	(cell) 650 799-1607
	kg6hvw@arrl.net	
Director ('09)	Gerry Tucker, N6NV	650-326 4908
	n6nv@arrl.net	
Director (09)	Byron Beck KG6UOB	408-735-8604
	kg6uob@arrl.net	

Appointed Positions

Membership	Vic Black, AB6SO	650-366 0636
	ab6so@srm.com	
Database	Rick Melrose K6RDM	1-888-725-1895
	k6rdm@arrl.net	
Chaplain	Rev. Rick Line, KG6TMD	650 323 8544
	kg6tmd@arrl.net	
Public Affairs	Vacant	
Station Trustee W6OTX, K6YQT, W6ARA....	Gerry Tucker, N6NV	
Station Trustee K6OTA....	Ron Chester, W6AZ	
Property Manager	Gerry Tucker, N6NV	
Fund Raising Coordinator	Bob Korte, KD6KYT	408 396 4745
	bob@rgktechsales.com	
Badge Coordinator	Ed Gentry KG6KKP	650-368-9455
Historian	Christopher McIntyre, KG6SVI	
Raffle Coordinator	Jim Rice, K6AK	650-851-2274
Ticket Master	Kyle Rice, KG6MSK	
Field Day Coordinator	Doug Teter, KG6LWE	
ASVARO Rep	Rolf Klibo, N6NFI	650-856-2748
	n6nfi@arrl.net	
Webmaster	Peter Sheerin K6WEB	415 298 7383
	k6web@arrl.net	
Technical Coordinator	Joel Wilhite, KD6W	650-325-8239
	kd6w@arrl.net	
QSL Manager	Rob Riley, KI6INR	(cell) 650 799-1607
	ki6inr@arrl.net	
Speaker Coordinator	Doug Teter, KG6LWE	650 325 8239
	dteter@wvwi.com	

PAARAgaphs Staff

Editorial Board

PAUL PETACH KI6QXV	ROBIN YEE KI6YTA
Joel Wilhite KD6W	Vic Black AB6SO
Ron Chester W6AZ	Peter Sheerin K6WEB

Editors

.....	Paul Petach, KI6QXV	
.....	Robin Yee, KI6YTA	
Advertising	Ron Chester, W6AZ	408-243-2221
.....	ron@taxhelp.com	
Member Profiles	Terry Finn, AA6T	650-366-9111
Technical Tips	Vic Black, AB6SO	650-366 0636
	ab6so@srm.com	
Photographer	Bill Young, K6VWO	
	k6vwo@sbcglobal.net	

Continued from page 35

PAARA LXpeditionary Force operatives: Dave Crocker W6VYC, Tim Dolan K6OM, Vic Black AB6SO, Hiro Kato AH6CY, Reg Dell-Aquila K6SSJ and Kristen McIntyre K6WX have recently been operating portable next to SF Bay and on nearby mountain tops. Hiro reports his best DX: Spain with 2-1/2 watts phone. Operation is by battery power into portable antennas. Most QSOs are QRP SSB with “salt water amplifier” --- enough to work Europe, Asia, South America and Oceania on 17 and 20 meters SSB at the bottom of the sunspot cycle. Popular radios are FT-817, IC-703/706, various Elecraft portable rigs and some military surplus with Automatic Link Establishment...

Other dignitaries seen by the bay: Elecraft co-founder Wayne Burdick N6KR and Bonnie Crystal KQ6XA, founder of the 8,000 member HF Pack group. Bonnie works pedestrian mobile and bicycle mobile on her supine recumbent bicycle when she's not in Shanghai on business. Others include Daniel Dibbets AF6FZ, Rhona Mahony K6PHO (love that suffix), Neil Murphy KH6EAM, Darryl Presley KI6LDM and PAARA Veep Doug Teter KG6LWE. Dave Flack W6DLF has been using the standalone, battery-operated NUE-PSK digital modem which allows him to operate PSK31 without the usually required computer...

Confusion: Poor Ol' Mr. Pho is trying to improve his English, but is confused. Why do Americans say fish after tuna, but not after salmon or sardines? Why do they say Myanmar, formerly Burma, or Mumbai, formerly Bombay, but not Thailand, formerly Siam, or Sri Lanka, formerly Ceylon, or Tanzania, formerly Tanganyika, or Namibia, formerly German South West Africa, or Zimbabwe, formerly Southern Rhodesia, or United States, formerly the American Colonies? After a tour of the United States Ol' Pho wonders if United States is a misnomer...

Fun and Fame: Gentleman Jack Troster W6ISQ is PAARA's Sweepstakes “check 35” (his first year of operation). Jack recently announced that he finally worked his last DXCC country for a complete sweep of all countries. And it only took 50 years. It's somewhat like working to get rich. The first million is the difficult part. It's amazing how easy it is to work DX during a contest and how difficult it can be when there is no contest on. Is it important to work every country? No. If you set that as a goal true happiness will elude you. In Punjabi State there is an old adage: “Slowly, slowly catchee monkey.” Get impatient and he will always stay out of range. Will you become world famous if you do work 'em all? Not for long. Cemetery marble head stones should prove that. Chase DX for enjoyment and the pleasures of friendship. They will remain with you forever...

Live the Dream. Grab the Airwaves and hang on. Enjoy the ride.

(Continued from page 37)

his helmet and have him transmit live pictures while operating handheld. The melding of technology would then allow him to send video of what he can see from his perspective just as if we were there with him. Dick Kors (KM6EP) had this idea on a little remote control airplane fitted with a 2.4GHz camera and an APRS 2m beacon strapped to it flying around the Field Day site one year. How much longer will we have to wait for remotely piloted amateur radio equipped dirigibles? Can you imagine an airship effortlessly hovering over an area with repeater system (but not on 2 meters!) and live video down-links giving us a view only the birds get to enjoy regularly?

73 de KD6W
Joel

Congratulations to the winners of the August 7th PAARA Raffle!



THANK YOU FOR YOUR SUPPORT of the exciting monthly raffles!

PAARA had a remarkable year in 2008! If you aren't a member, please join PAARA now and experience fun 2009 events with the “friendliest club around.”

K6AK Jim

PAARA Exemplary Service Award

Gerry Tucker, N6NV 2005

Rice Family 2006

Jim K6AK, Lisa KG6KQS, Kyle KG6MSK

Wally Porter, K6URO 2007

Vic Black, AB6SO 2008

??? - 2009



PAARA “The Friendliest Club Around”

Palo Alto Amateur Radio Association Presents...

Friday, September 4th at 7 p.m.

Menlo Park Rec. Center, 700 Alma St., Menlo Park, CA.

September Raffle Prizes

FIRST PRIZE: Icom IC-V82 / 2m / 7W / HT



Includes 600mAh Ni-Cd Battery Pack with Desktop Charger

- 200 Memory Channels and Ten Memory Banks
- NOAA Weather Channel Receive
- Automatic Repeater Function
- Durable Construction and Simple Operation
- Optional Digital Unit UT-118 / Provides D-STAR Digital Voice and Data
- PC Cloning Capability

SECOND PRIZE: Eight Cell Smart Charger with 8 AA 2100mAh Rechargeable Batteries



THIRD PRIZE: Deltran Battery Tender / 12Volt / 750MA / 3 Charging Modes

FOURTH PRIZE: TWO Midland Two-Way Radios with Batteries & Charger

FIFTH PRIZE: Where Did Silicone Valley Begin? On The Radio! DVD

SIXTH PRIZE: ARRL Repeater Directory 2009-2010

SEVENTH PRIZE: Sterling Deluxe Wire Stripper

EIGHTH PRIZE: Yaesu Log Book

Since Feb. 03, 150 Radios, including TWO Elecraft K3's, a Yaesu FT-847, an Icom 706 MK IIG, a Yaesu FT-897D, and TWO Elecraft KX1's have gone to Fellow Hams.

A special thanks to Bob, Howard, Dan, Mark, and everyone at HRO for their continued support!

A Point-to-Point Wireless Solution for CAT5 connectivity

By Patricia (Elaine) Gibbons WA6UBE

This article presents a wireless solution that is a 'Commercial Off the Shelf' (COTS) arrangement.

At our home QTH, a solution needed to be found for providing internet connectivity to our COMVAN, which is usually parked behind our home when not in use (actually, it is parked behind our house most of the time even when it *is* in use).

Using a PCMCIA Netgear wireless card in this particular application proved useless, as the laptop PC is inside of a metal communications shelter, and even with the door of the shelter opened, connectivity was very spotty even though the RF path length is only 75 feet. It is clearly obvious that the internal patch antenna of this wireless card will not provided the needed connectivity to the wireless LAN in our home.

Our prior effort at wireless connectivity to our wireless LAN from our comvan:

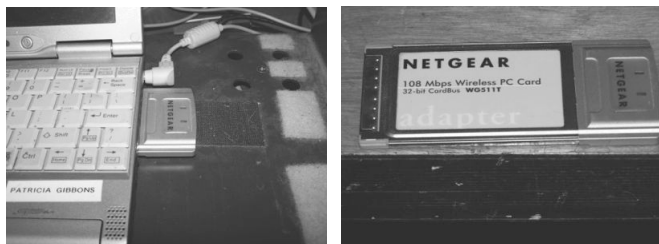

Running a length of CAT5 or CAT6 Ethernet cable to the vehicle seemed a "logical" solution except that such a run of cable would end up being directly underneath a 120-foot, HF multi-band dipole antenna which is strung diagonally across our property, at a height of about 15 feet.

Solving complex RFI problems in the past usually required the equivalent of some heavy voodoo or other form of magic in order to eliminate such RF interference. Given this experience, the thought of running 75 feet of CAT5 cable from our house to the comvan in this particular case did not seem to be the best idea to pursue.

The unique application in this case was the use of high-gain directional antennas at each end of the connection path, and the use of two NetGear WG102 wireless access points which are configured in "bridge mode".

"Bridge mode" in the usual sense, is for the purpose of connecting two separate local area networks together so that any pc in one network can access resources on the other. "Bridge mode" essentially is a dedicated point to point link, where only two

MAC addresses are used. Each access point has it's own internal MAC address, and as part of the bridge-mode configuration, also has the MAC address of the access point it is pointing towards configured in its setup.

In this mode, such a link will appear to the "far-end user" (in this case the notebook PC within the comvan) only appear connected to the internet via a CAT5 Ethernet cable.

A real benefit of using Netgear products is that many of their devices are designed to be powered from a 12 volt-DC source, and usually via a wall-wart. In a vehicular environment, what could be better than equipment that can be plugged directly into an Anderson Powerpole strip??

As cable losses at 2.4 GHz can be huge when long lengths of cable are used, this solution required only 2-feet of antenna cable from the access point in our front room, to a Hawking corner reflector antenna having 15 dBi gain, and only a three foot RF cable from the access point in the comvan to a model WAN2218, 18 dBi enclosed Yagi antenna which is made by a company called "Level One."

*Level One WAN2218 Antenna mounted to our COMVAN.
This radome-enclosed multi-element yagi antenna is just over four feet in length:*



View of the WG102 Access point, connected up in our COMVAN:



Below is the indoor-end of this wireless link, consisting of a Hawking Corner reflector antenna, installed in our living room, and connected to the indoor Netgear access point. A CAT5 cable then connects the access point to a Linksys DSL modem's internal Ethernet router:



Using a USB2.0 port via the new card for use via the MLXW soundcard software. The digital data is sent to a Tigertronics SignaLinkUSB interface and then connected to a Yaesu FT897D via the data port on the back of the radio:



Rear view of the Netgear, WG102 Access point:



Front view of the Netgear WG102 Access point:



Inside the comvan where my notebook computer is used:



For more information on the access point and the antennas, go to

Netgear WG102 Access Point: <http://tinyurl.com/wg102>
Hawking HAI15SC corner reflector antenna: <http://tinyurl.com/hai15sc>
Level One, WAN-2218 Antenna: <http://tinyurl.com/ld9q3l>

Also be sure to check out Elaine's web site, <http://www.tactical-link.com>



James Farrey
 Sales Manager

James Electronics Ltd
 1355 Shoreway Road, Belmont, CA 94002
 Tel: 650•592•6718 x 350 Fax: 650•802•1520
 Direct: 650•802•1511 jfarrey@jameco.com

www.jameco.com

YOUR AD HERE
See the next
page for details

Badges in hand as of 8/02/09

- KG6QKO, Kali, Palo Alto
- N6JCY, Joani, San Jose
- K4AZY, Mike, Palo Alto
- KI6GYG, Art, San Jose
- KG6QKN, Francis, Palo Alto
- K6TSR, George, Portola Valley
- N6MEF, Michael, Los Altos (2)
- KG6ZWO, Henri,
- KF6SRD, Chuck, Daly City
- K6FTF, Mark, SJ
- W6NEV, Marty

73 de Ed, KG6KKP, Badgemeister

PAARA Weekly Radio Net

Info and Swap Session every Monday evening
 8:30pm on the N6NFI 145.230 MHz repeater.

Control operators:

Week	Operator
1 st	Paul Petach KI6QXV
2 nd	Doug Teter KG6LWE
3 rd	Peter Sheerin K6WEB
4 th	Doña Kerns KI6DAR
5 th	Mike Bray N6MEB

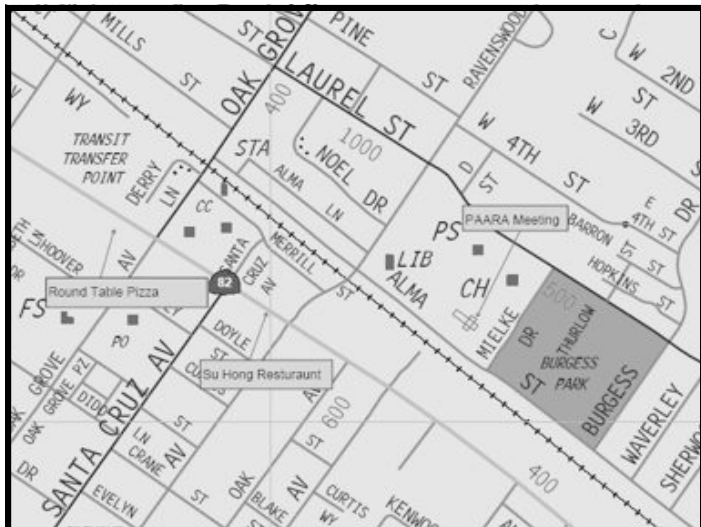

Directions to PAARA meeting:
<http://paara.org/meetings/>



Join us for pre-meeting eyeball

Eye Ball QSO gab & gobble

Food will be served at 6:00 sharp, so guests will be on time for the PAARA meeting. Those arriving late will be responsible for their own food order.

5:30 pm—at Su Hong Restaurant
1039 El Camino Real
Menlo Park

across from Kepler's Book Store
on El Camino Real
Walking distance from Caltrain!

Palo Alto Amateur Radio Association

P.O. Box 911, Menlo Park, California 94026-0911

Club meetings are on the first Friday of each month, 7:00pm at the Menlo Park Rec Center, 700 Alma Street, Menlo Park, CA.

Radio NET & Swap Session every Monday evening, at 8:30pm, on the 145.230 –600 MHz repeater, PL tone off.

Membership in PAARA is \$20.00 per calendar year, which includes one subscription to PAARAglyphs \$6 for each additional family member (no newsletter).

Make payment to the Palo Alto Amateur Radio Association, P.O. Box 911, Menlo Park, CA 94026-0911

Permission is granted to reprint from this publication with appropriate source credit.

**PAARA
 Radio Net**

**Every
 Monday
 evening
 at 8:30
 P.M. local
 time
 on the
 145.230
 –600 MHz
 repeater,
 PL tone
 not re-
 quired**

Ilse Beck, E. A. , KI6IBM

Beck Business Services

441 N. Central Avenue, #9
 Campbell, CA 95008

Enrolled Agent
 Income Tax
 Bookkeeping/Payroll
 Elder Care
 Consultations
 Billing and A/R

Phone/FAX: 408-267-8234
 Email: ilsebeck@jps.net

W6AZ



Ron Chester
 Santa Clara
 (408) 243-2221
 Ron@taxhelp.com

Tax Preparation & QuickBooks Consulting - Ham discount

Photo For Any Occasion

Jack Of All Trades, Master Of Some.
 Freelance Photographer

Bill Young

PO Box 471
 Mountain View, CA
 94042

408-245-1161

jdsinger@sbcglobal.net

View Photos.

http://www.slide.com/r/PZIHjUev0D-CcHE_Gt6m6rdKbPtUyz6m?previous_view=mscd-embedded_url&view=original

**MADONNA'S
 BAIL BONDS**



Ayudamos a la Comunidad Hispana



REDWOOD CITY — **650-366-9111**
 SAN FRANCISCO — **415-495-2245**
 SAN JOSE — **408-266-2245**

TERRY FINN CA Insurance License # 1A38965, AA6T
 234 Marshall Street, UPSTAIRS #3 Redwood City, CA 94063-1550

PowerFlare®

PowerFlare® safety lights:
 Ultra-rugged 360 degree LED beacon
 for your emergency kit, car, home ...
Order on eBay or call 650-322-2476
 (search for "PowerFlare")

<http://www.foto.mail.ru/list/shkurkin>

Vladimir Vladimirovich

SHKURKIN

Editing and Translation Services
 English-Russian-English

shkurkin@ix.netcom.com

PAARAgaphs E-mail address:

kd6w@arrl.net

Submit material for PAARAgaphs by the 15th

Text: MSWORD, RTF, or TEXT

Photos: JPEG or TIFF raster images

Missing PAARAgaphs, too many copies, wrong name or
 call on label? Contact Database Manager:
 Rick Melrose K6RDM, 1-888-725-1895, k6rdm@arrl.net

PAARAgaphs Ad Rates

PAARAgaphs accepts paid advertisements from non-members. (short personal ads remain free for members in good standing). All ad rates listed are per issue.

1. Not-for-profit ads by association members for ham-related items and wants. No cost for business card-size ads (additional space at \$2.50 per business card size per issue).

2. For Profit organizations and/or individuals: \$5-business card size, \$25-half page, \$50 full page or back cover per issue.

These fees may be reduced or waived in exchange for a valuable consideration that is given to the Association or its general membership. Such consideration must be in addition to any existing arrangements with the association. The PAARAgaphs editors reserve the right to reject any ad deemed to be not in the best interest of the Association.

All fees payable in advance by the year with "scanner-ready" copy or text-only ads. Give payment and copy to Ron Chester, W6AZ

